

**Inch**

Screw Size	Part Number	TPI	ID inch/mm	L inch/mm	OD inch/mm
4	SW-4	42	.183/4.65	.102/2.59	.562/14.27
5	SW-5	48	.205/5.21	.113/2.87	.562/14.27
6	SW-6	54	.226/5.74	.125/3.18	.562/14.27
8	SW-8	58	.270/6.86	.147/3.73	.562/14.27
10	SW-10	64	.312/7.92	.170/4.32	.562/14.27
10	SW-10-1	64	.312/7.92	.170/4.32	.875/22.23
1/4	SW-14	70	.375/9.53	.225/5.72	.875/22.23
1/4	SW-14-1	70	.375/9.53	.225/5.72	1.000/25.40
5/16	SW-31	78	.469/11.91	.282/7.16	1.000/25.40
3/8	SW-37	84	.562/14.27	.340/8.64	1.000/25.40
7/16	SW-43	88	.656/16.66	.393/9.98	1.252/31.80
1/2	SW-50	94	.750/19.05	.450/11.43	1.252/31.80

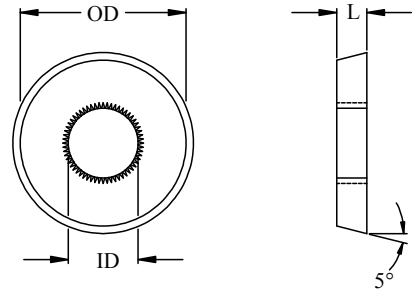

1. M-2 Material at 58-60RC.
2. Special materials available upon request.
3. PVD Coatings available.